



American University Facilities Planning Working Group

January 16, 2024

Agenda:

- Call to Order and Welcome.
- Jacobs Field Sound Barrier Update.
- Community Garden Relocation Update.
- Meltzer Center Construction Update.
- Open Floor Discussion on Other Facilities Planning Issues
- Closing Comments and Adjourn.



Ground Rules:

- Respect the process.
- Be present and engaged.
- Follow the Facilitators' directions.
- Allow every voice to be heard.
- Speak courteously and respectfully to others.
- Maintain zero tolerance for any comment (written or verbal) that is meant to attack or intimidate another person or is obscene.



Jacobs Field Sound Barrier Update

Schedule



				2023												2024						
				October			November			December			January		Feb							
				Week 41	Week 42	Week 43	Week 44	Week 45	Week 46	Week 47	Week 48	Week 49	Week 50	Week 51	Week 52	Week 1	Week 2	Week 3	Week 4	Week 5	Week 6	
				10/9-10/13	10/16-10/20	10/23-10/27	10/30-11/3	11/6-11/10	11/13-11/17	11/20-11/24	11/27-12/1	12/4-12/8	12/11-12/15	12/18-12/22	12/25-12/29	1/1-1/5	1/8-1/12	1/15-1/19	1/22-1/26	1/29-2/2	2/5-2/9	
Location	Work Days	Resp. Party	Item																			
American University - Jacobs Field Soundwall																						
	1.0	JBA	Survey - Jobsite Layout	█																		
	3.0	TSC	Utility Locating/Marking	█	█																	
	2.0	Hercules	Remove Existing Fencing		█	█																
	3.0	Hercules	Install Tree Protection Fence			█	█															
	3.0	Bartlett	Tree Removal and Mulching			█	█															
	2.0	Hawkins	Install Silt Fence				█	█														
	5.0	Hercules	Install Ground Protection Matting Over Mulch				█	█	█													
	25.0	Hercules	Drill Soundwall Foundations, Install Rebar & Anchor Bolts, Pour Concrete					█	█	█	█	█	█									
	25.0	Stevenson Consulting	Concrete Testing					█	█	█	█	█	█									
	5.0	Hercules	Install Sound Wall Posts and Grout							█	█	█	█									
	5.0	Hercules	Install Sound Wall Panels										█	█	█							
	5.0	Hercules	Install Sound Wall Flange Covers and Caps												█	█	█					
	2.0	Hercules	Remove Tree Protection Fence and Ground Protection Matting													█	█	█				
	3.0	TSC	General Clean Up and Light Grading														█	█	█			
	2.0	TSC	Demobilize Tools and Equipment															█	█			
	10.0	TJ Lawn	Site Landscaping (Spring Planting Season)																		█	█

Progress Photos



Progress Photos





Community Garden Update

Location

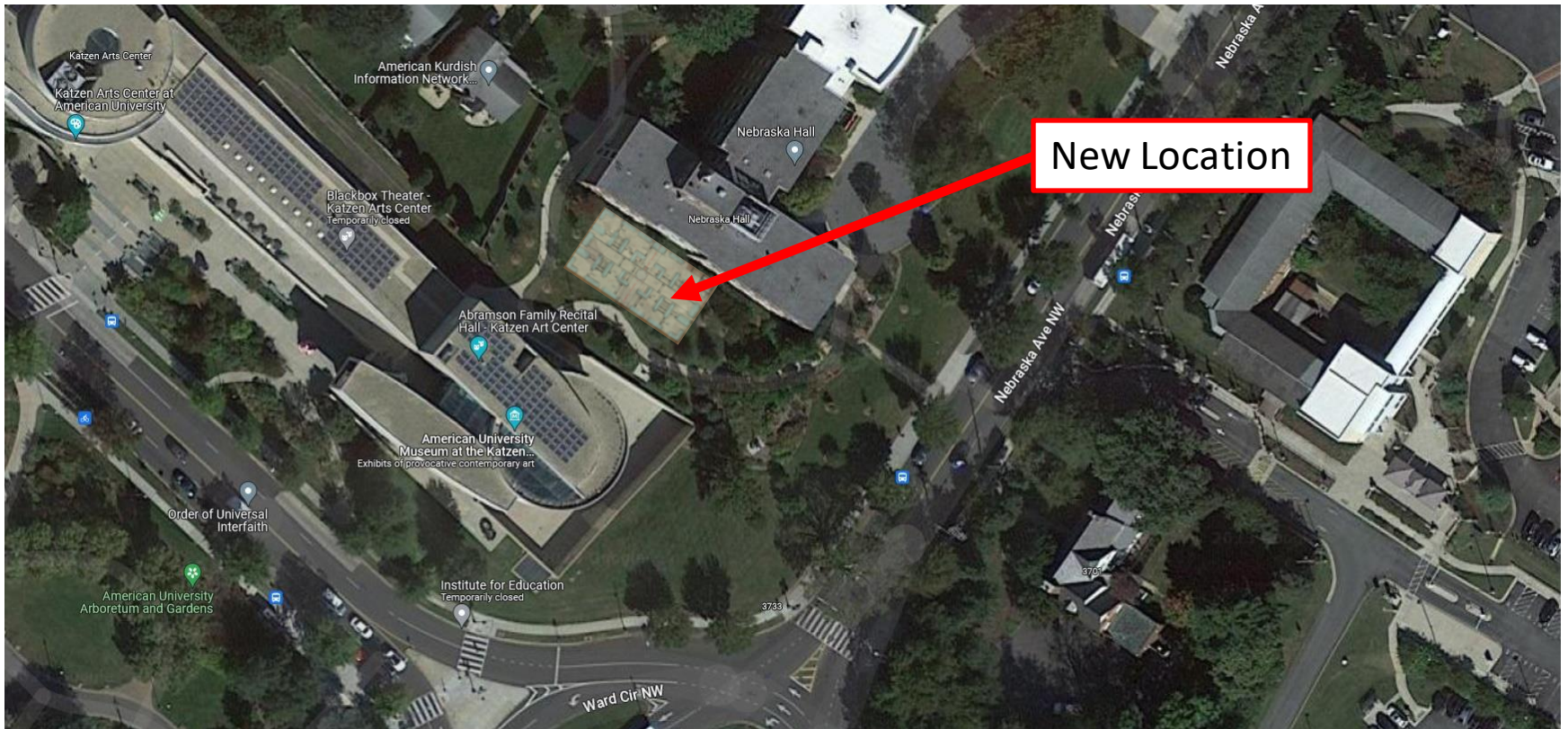

Design

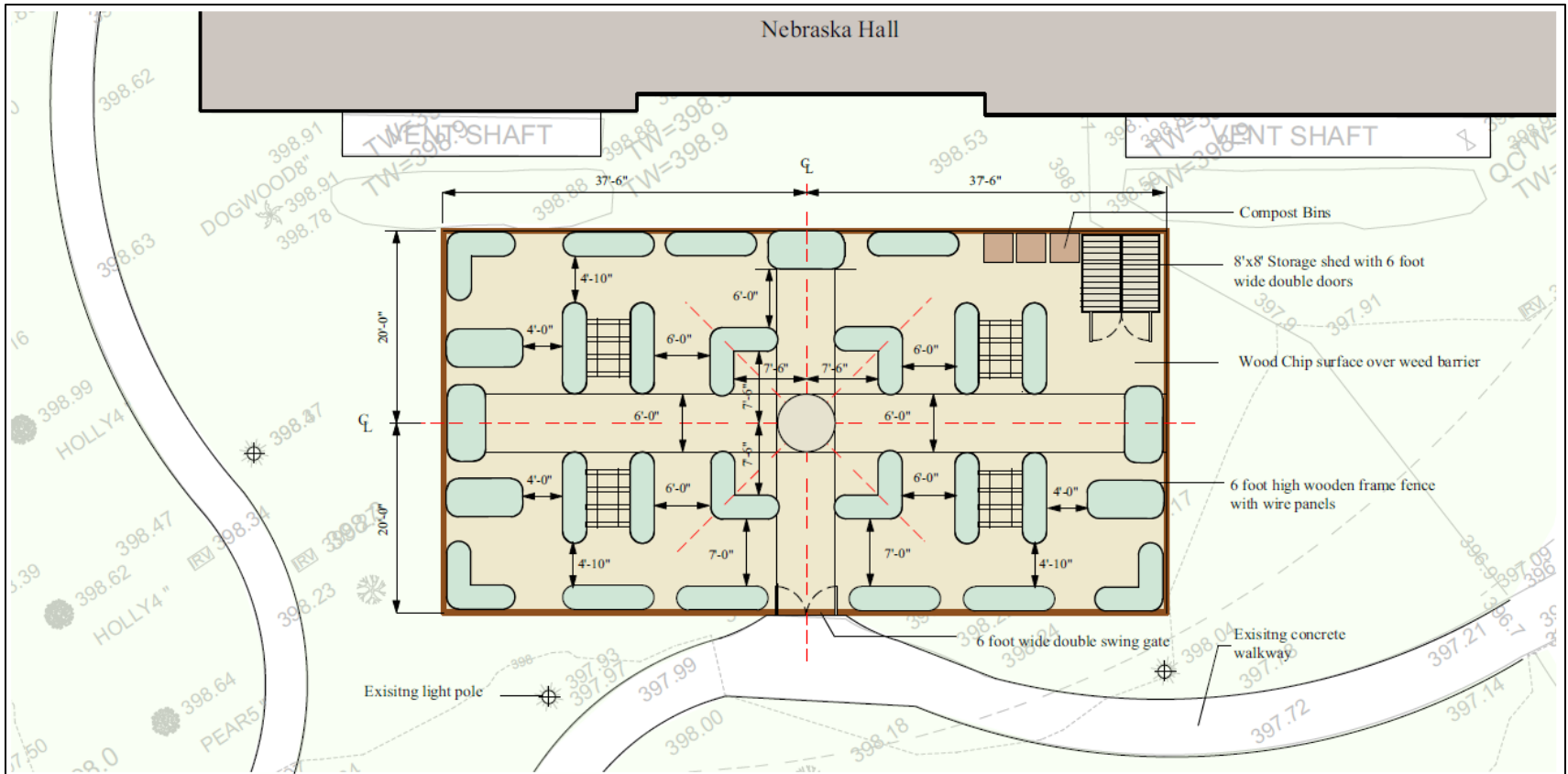

Features



- Raised planting beds.
- Small storage shed (8'X8' or 8'X10').



Meltzer Center Construction Update

Updates

- The main building permit has not yet been received.
- Date for closing courts planned to be communicated this week.
- Community garden relocation planned to begin in early February.
- Locating and verification of site utilities planned for February.
- Groundbreaking ceremony being planned for March.
- Construction activities hopefully may begin as soon as possible following groundbreaking ceremony.*

*Final dates TBD and pending release of required permits

Construction Management Plan (20-31B - Exhibit 2K)

- Work hours.
- Traffic Management and Parking.
- Site Management.
- Contractors and Subcontractors.
- Communication.



**ALAN AND AMY MELTZER CENTER AND SPORTS CENTER ANNEX
CONSTRUCTION MANAGEMENT PLAN**

Construction activities in connection with the development of the Alan and Amy Meltzer Center for Athletic Performance and Sports Center Annex ("Meltzer/SCAN") on the campus of American University ("AU" or "University"), subject to the approval of the DC Zoning Commission, will be conducted in accordance with the terms of this Construction Management Plan (the "Plan"), as detailed below:

1. **Work Hours**
 - a. The normal construction work week will be Monday through Friday from 7:00 a.m. until 6:00 p.m. Work may also be conducted on Saturdays from 9:00 a.m. until 5:00 p.m., as needed to maintain the project schedule. No construction activity will occur on Sundays.
 - b. AU will make good faith efforts to limit noisiest and most disruptive work to between 8:00 a.m. and 4:00 p.m. on weekdays.
2. **Traffic Management and Parking**
 - a. All access to the Meltzer/SCAN construction site will occur from AU property, with the limited exception that vehicles associated with planting activities within the vegetative buffer along the campus boundary with University Avenue may, if necessary, access the site from University Avenue.
 - b. Construction vehicle access will occur primarily using the Massachusetts Avenue campus access point (Glover Gate).
 - c. Queuing of construction related vehicles will not occur at any time on adjacent neighborhood streets.
 - d. All deliveries of project-related materials, construction or otherwise, will occur only during the Work Hours specified in Section 1.
 - e. Designated contractor and construction worker parking areas will be provided on the AU campus. Consistent with AU's Good Neighbor Parking Policy and Condition 46(b) of the 2021 Campus Plan, construction employees, contractors, and subcontractors shall by contract be prohibited from parking on residential streets, subject to contractual penalties of termination.
3. **Site Management**
 - a. AU will erect and maintain temporary fencing and barricades in order to secure the construction site and will maintain temporary storm water management systems

Sign Up for Construction Updates

Scan QR Code



Or go to

<http://tinyurl.com/MOutreach>



Open Floor Discussion on Other Facilities Planning Issues



Closing Comments and Adjourn